

Delegated Decision

18 January 2023

Temporary Traffic Regulation Order

Ordinary Decision/Key Decision No.



Report of NEIGHBOURHOODS AND CLIMATE CHANGE

Paul Watson – Strategic Highways Manager, Technical Services

Electoral division(s) affected:

Ferryhill

Purpose of the Report

To consider a request for temporary traffic regulation by Order on Monday 20 February 2023 at Magdalene Place, Ferryhill for the purpose of Northern Gas main repair works.

Recommendation

It is recommended that the Council exercises its powers under the Road Traffic Regulation Act 1984 to effect a Temporary Traffic Regulation Order to facilitate the proposed works.

Background

Gas main repair works are proposed to be undertaken.

Options

Other traffic management arrangements have been considered and the most appropriate method is for temporary road closure

Recommendation

The recommendation is approved and that following, consultations with the Chief of Police, arrangements be made to progress the advertising of Public Notices and sealing of an Order.

Contact: Nicola Longstaff

Tel: 03000 263679

Appendix 1: Implications

Legal Implications

TTRO checked, prepared and advertised via Legal Services.

Finance

Costs to be charged to the scheme/applicant.

Consultation

Chief of Police, Local Members, Public Transport Providers (via the Public Transport Team)

Equality and Diversity / Public Sector Equality Duty

N/A

Human Rights

No impact

Crime and Disorder

N/A

Climate Change

N/A

Staffing

Network Management Team

Accommodation

N/A

Risk

N/A

Procurement

Advertising in a public newspaper with costs recharged to the scheme/applicant.

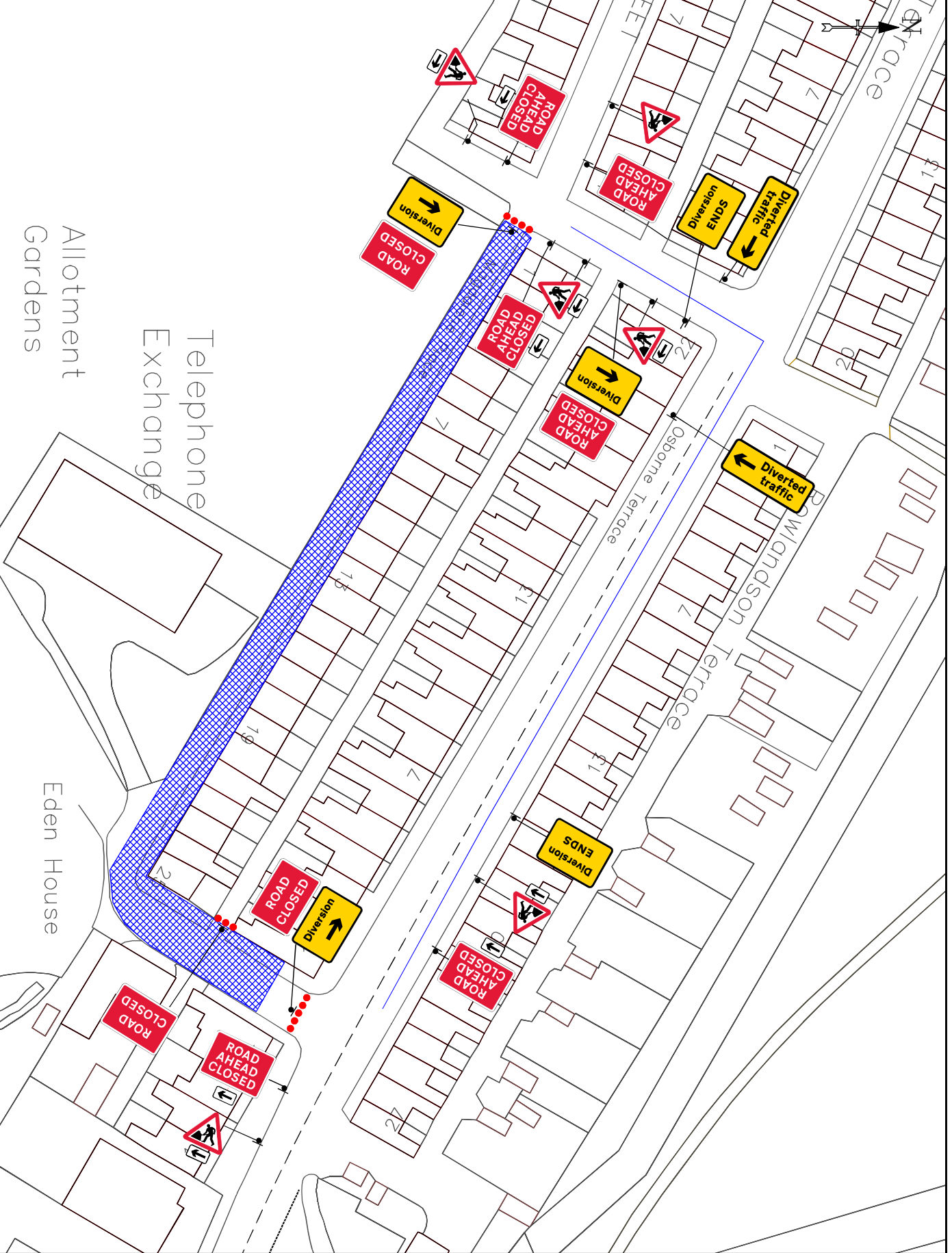

Telephone Exchange
Allotment Gardens

Eden House



TEMPORARY TRAFFIC MANAGEMENT
30 MPH

| Issue | Date |
|----------|----------|
| 1 | 12/12/22 |
| Drawn By | JC |

ROAD CLOSURE + DIVERSION
MAGDALENE PLACE, FERRYHILL
DL17 8BA

Original drawing size A3 - NTS
Drawing Ref: NGN

Notes -

KEY

- Traffic sign
- Traffic cone
- Working Space
- Pedestrian Barrier



Specials -

| Temporary works | Standard temporary works including cones and signs | Restricted cone and sign vehicles only |
|-----------------|--|--|
| 1.5m x 1.5m | 1.5m x 1.5m | 1.5m x 1.5m |
| 1.5m x 2.0m | 1.5m x 2.0m | 1.5m x 2.0m |
| 2.0m x 2.0m | 2.0m x 2.0m | 2.0m x 2.0m |

DETAIL B

15m

DETAIL D

15m

Notes:

- 1) During darkness, warning lights to BS EN 12389:2006 should be provided in accordance with Table A.3 (Appendix 1).
- 2) Detail D applies only to extension cones.

Notes:

- Single dual carriageway, single or two-lane - 450mm traffic cones, spacing 1.5m.
- Single dual carriageway, dual or three-lane - 450mm traffic cones, spacing 1.5m.
- Dual carriageway/national speed limit - 750mm traffic cones, spacing 1.5m, reduced 5m.

Notes:

- 2) 40° tapered cones, warning lights to BS EN 12389:2006 should be provided in accordance with Table A.3 (Appendix 1).
- 2) 40° tapered cones, warning lights to BS EN 12389:2006 should be provided in accordance with Table A.3 (Appendix 1).
- Cones will be required for both standard and relaxation works for road signs and the bearing with of line changes.